

Current Road works on the Peninsula Link Freeway are continuing to 15 November 2025

Community notification

September 2025



Peninsula Link is carrying out major road works along 14 kilometres of the freeway to maintain a safe and reliable connection for drivers travelling between the Mornington Peninsula and Melbourne's south-east.

We are undertaking these works in sections, rebuilding the freeway from the ground up, replacing layers of pavement below the road surface to make it stronger and better suited to road conditions.

The next stage of works will involve reconstructing the southbound carriageway of the freeway between Bungower Road and Moorooduc Highway.

Please refer to the map overleaf.

When we'll be working

The current works will be extended to 15 November, before moving on to the next work area.

Works will be carried out during the day and night, seven days a week.

Exact work dates are subject to weather conditions.

Traffic changes: From 10am 17 September to 15 November 2025

To ensure the safety of motorists and our workers, lane and ramp closures will be in place within the work zone, as follows:

- All southbound lanes between Bungower Road and Moorooduc Highway, including the exit ramps to Mornington Tyabb Road and Moorooduc Highway, will be closed.
- The southbound entrance ramp from Bungower Road will also be closed for the duration of works. Detour via Bungower Road and Moorooduc Highway.

The service station junction will remain open at all times.

Motorists are advised to use alternative routes, allow extra travel time, and follow the instructions of traffic controllers and signage around the worksite.

Route 887 buses between Frankston and Rosebud will also detour around the freeway closure using Moorooduc Highway, resulting in longer journey times.

Please visit transport.vic.gov.au for the latest public transport updates.

What will this mean for you?

During the works, you may notice:

- workers and vehicles
- traffic controllers and signage
- road closures, reduced speed limits and extra travel time
- noise from machinery and equipment.

Stay up to date

For more information about the works visit peninsulalink.com.au or scan the QR code below. You can also contact us on 03 8592 6689.



Location of work (Southbound lanes)

To subscribe to the email distribution list for this project, please contact peninsulalink@servicestream.com.au

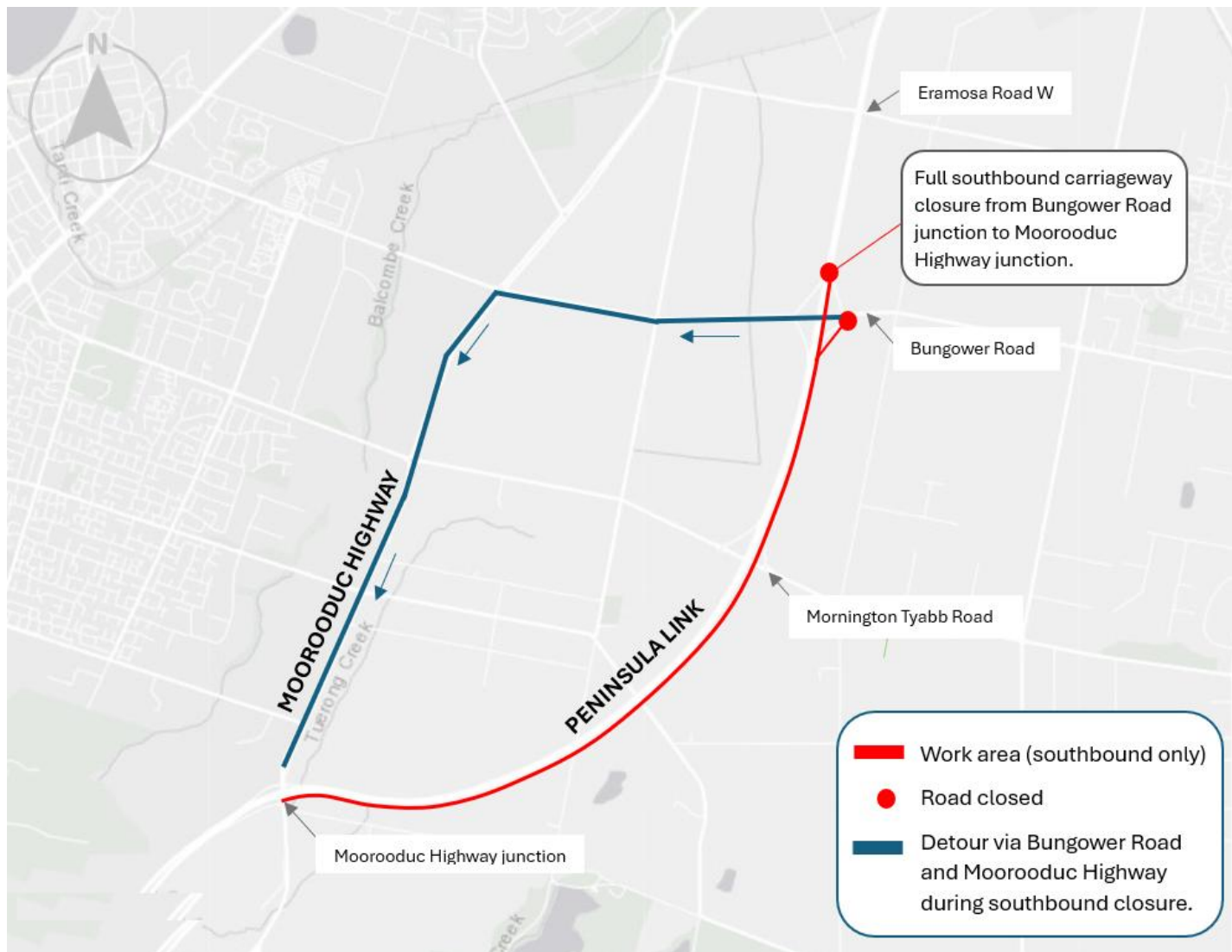

Contact us

If you have any questions regarding works on the Peninsula Link Freeway, please contact us using the details below. For more information regarding upcoming works, please visit our website.

 03 8592 6680

 peninsulalink@servicestream.com.au

 peninsulalink.com.au



If you need help understanding this information, please contact the Translating and Interpreting Service on 131 450.

